

UDAIPUR



THE LEELA PALACE

UDAIPUR

Places of interest

City Palace and Museum
Saheliyon Ki Bari
Maharana Pratap Memorial
Sajjan Garh (Monsoon Palace)
Shilpgram
Nathdwara
Ranakpur

*The Leela Palace Udaipur
offers a spectacular view of
the tranquil waters of the
Lake Pichola, the City Palace
and the Aravalli mountains,
evoking the grandeur
and opulence of the land
of Mewars.*

Climate

In summer, the min is 28°C
and the max is 43°C
In winter, the min is 8°C
and the max is 28°C

General information

Languages: English, Hindi,
Mewari
Currency: Indian Rupee
All major credit cards

LAKE PICHOLA

UDAIPUR

The elegant and contemporary interiors of the rooms and suites at The Leela Palace Udaipur are embellished with traditional elements of Rajasthani design and artistry. With a lake facing pool, spa and an array of restaurants and superlative lounges, the palace provides a fairy-tale setting for a royal Mewar experience.

www.theleela.com

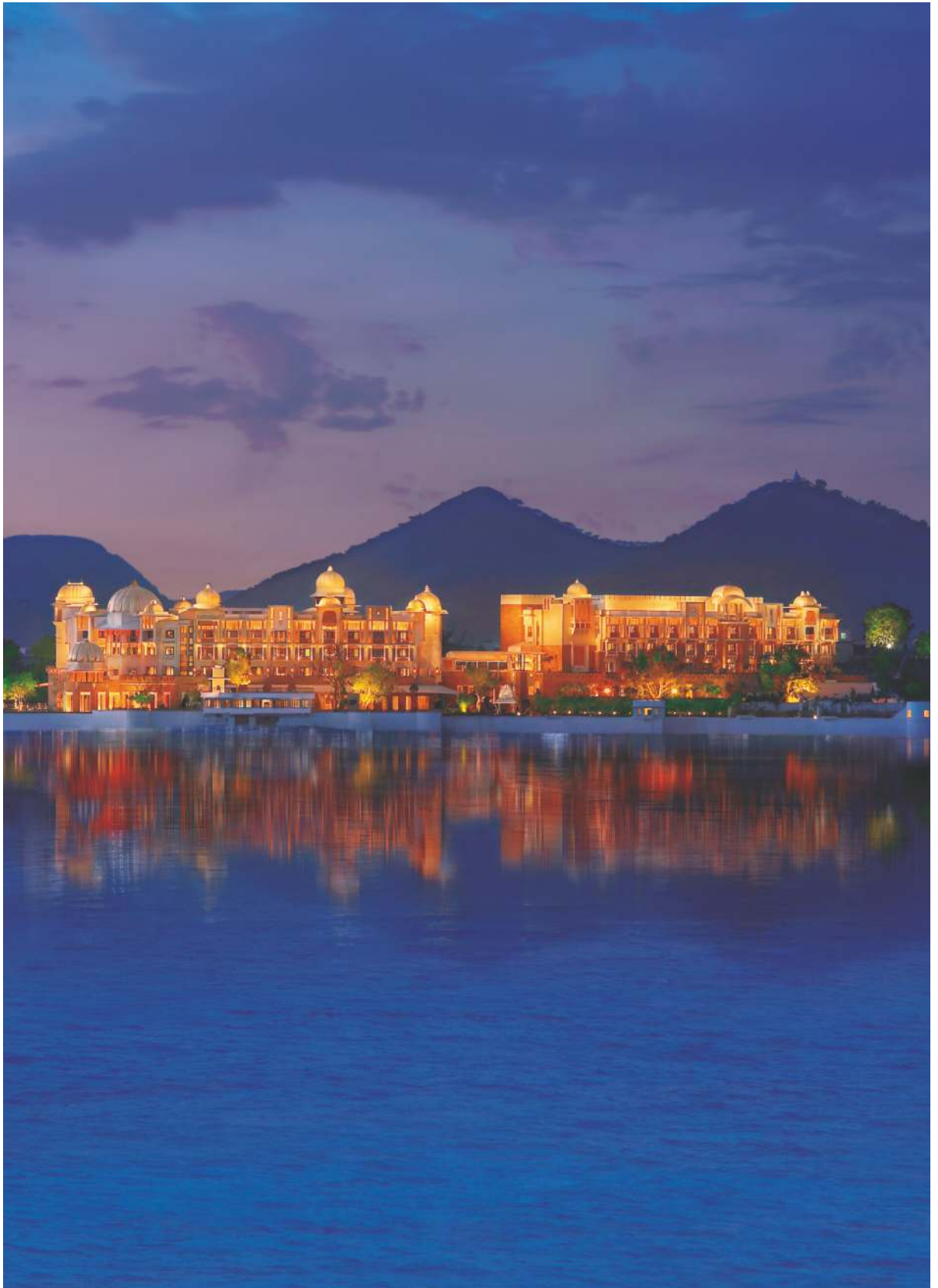

The Leela Palace Udaipur

Welcome to a place where the age old Indian tradition of "Atithi Devo Bhava", meaning "Guest is God", is a way of life. At The Leela, everyone is committed to taking guest service to reverential heights. "Welcome to a world of grandeur & luxury"

Accommodation

- Total no. of suites and rooms - 80
- 14 Grande Heritage Garden View Rooms
- 19 Grande Heritage Lake View Rooms
- 37 Grande Heritage Lake View Rooms with Balcony
- 2 Grande Heritage Garden View room with Private Pool
- 4 Luxury Suites
- 2 Duplex Suites
- 1 Royal Suite
- 1 Maharaja Suite

Guestroom Amenities

- High Definition LCD TV
- Broadband wireless high speed internet
- Electronic safe
- A gourmet corner with fine selection of spirits, soft beverages and snacks
- Selection of fine teas

Guestroom Services

- Round-the-clock butler service
- In-room dining
- Laundry and dry cleaning
- Wake-up call service
- Doctor on call

Dining

- The Dining Room - International cuisine
- Sheesh Mahal - Fine-dining Indian restaurant
- Walk-in wine cellar at The Dining Room
- The Library Bar - Time refined cognacs and single malts
- Destination Dining - Amrut Mahal, Sunset Alcove, Spa Alcove

Conference & Banquet

Facilities

- Marwar Conference Hall with a large open terrace
- Mewar Conference Hall
- 4 Meeting Rooms

- Inner Courtyard
- Outer Courtyard
- Guava Garden
- Croquet Lawn

Spa and Fitness

- The Spa
- Steam
- State-of-the-art fitness studio
- Outdoor swimming pool
- Heritage walk
- Croquet

Special Features

- The Salon
- Chauffeur driven luxury sedan cars
- Arrival in traditionally decorated boats
- Palace musicians
- Historian sessions
- Palace astrologer
- Puppet show (on request)
- Cultural performances
- Palace tuktuk



Al Fresco Dining



The Spa

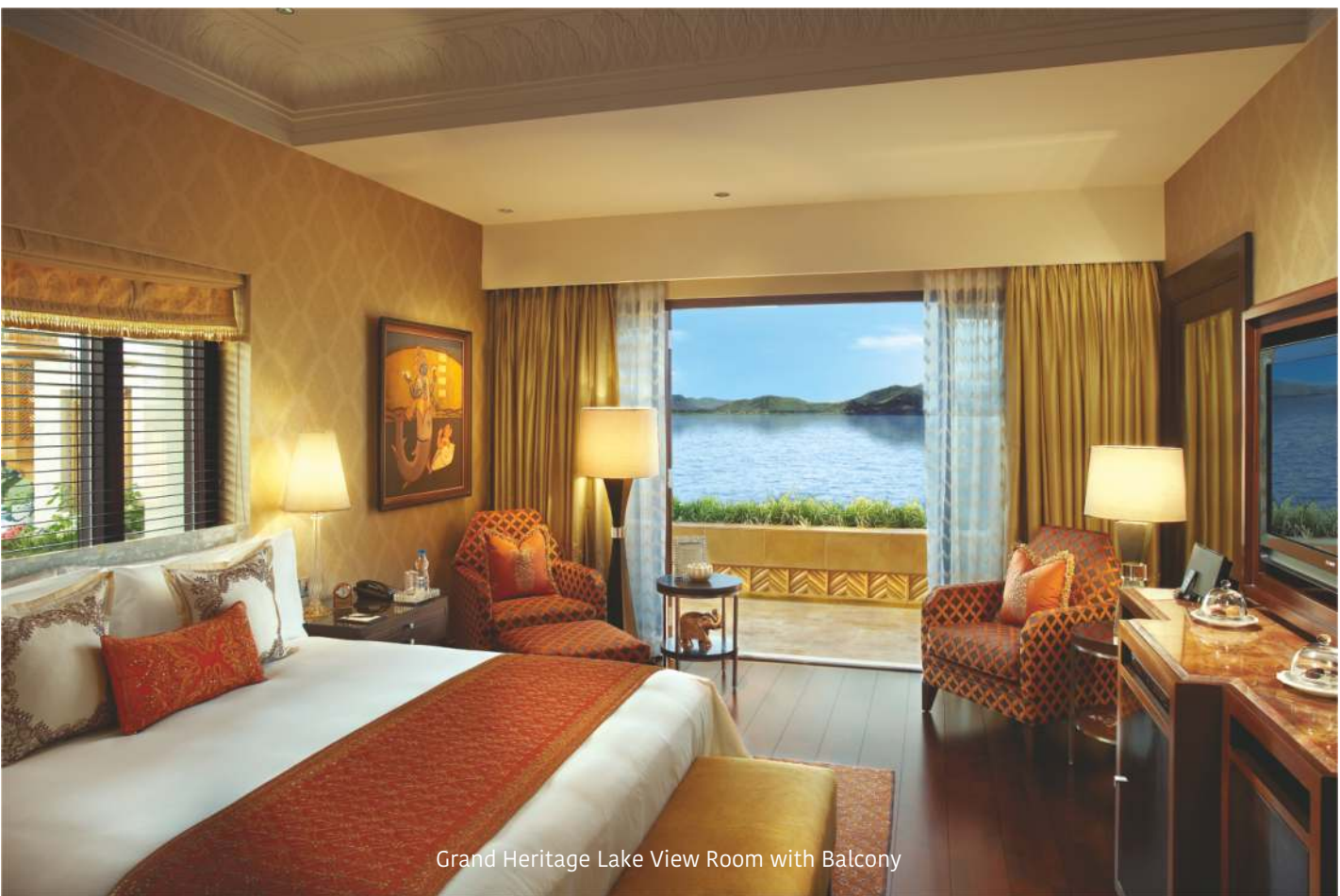

Grand Heritage Lake View Room with Balcony

BANQUET & MEETING ROOM FLOOR PLAN

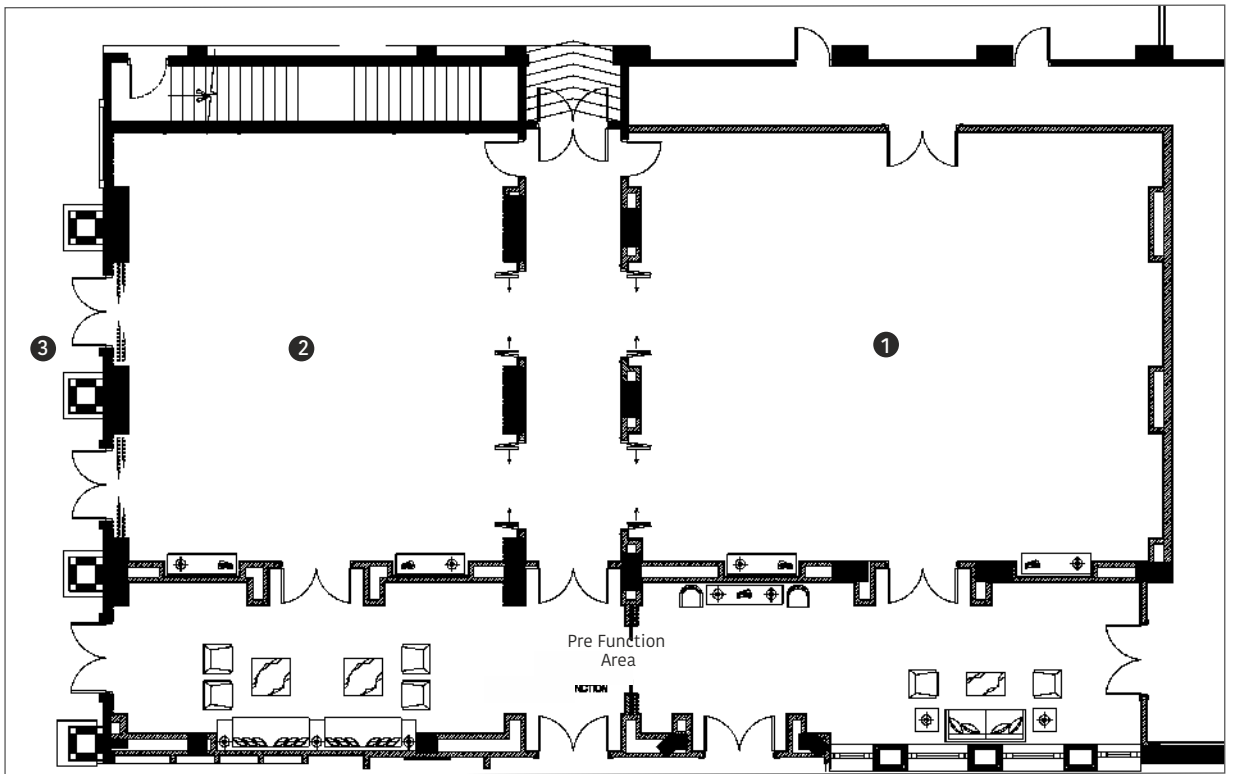

- 1 MEWAR
 2 MARWAR
 3 MARWAR TERRACE

| VENUE | AREA SQ. FT. | DIMENSIONS L x W x H | THEATRE STYLE | CLASS ROOM | U-SHAPE | BOARD ROOM | SIT/DOWN BUFFET | CLUSTER STYLE | RECEPTION |
|------------------------|-----------------|-------------------------|------------------|---------------|---------|---------------|--------------------|------------------|-----------|
| Mewar Conference Hall | 1700 | 46 x 37 x 13 | 120 | 60 | 36 | 48 | 90 | 72 | 100 |
| Marwar Conference Hall | 1295 | 35 x 37 x 12 | 60 | 36 | 24 | 32 | 60 | 48 | 60 |
| Marwar Terrace | 2788 | 82 x 34 | 160 | | | | 80 | 85 | 100 |
| Payal | 393 | 28 x 14 x 9 | | | | 8 | | | |
| Bindiya | 530 | 25 x 21 x 8 | | | | 10 | | | |
| Kangan | 546 | 25 x 17 x 8 | | | | 10 | | | |
| Royal Boardroom | 540 | 34 x 19 x 7 | | | | 14 | | | |



TRANSPORTATION

Domestic Airport, 28 km
City Centre, 4 km

The Leela Palace Udaipur

Lake Pichola, Po Box No. 125
Udaipur 313 001 Rajasthan India
Tel: +91 294 670 1234
Fax: +91 294 670 1212
e mail : reservations@theleela.com

RESERVATIONS & INFORMATION

THE LEELA PALACES, HOTELS AND RESORTS

GDS CHAIN CODE: LR

THE LEELA RESERVATIONS

WORLDWIDE TOLL FREE

| | |
|----------------------|--------------------------|
| INDIA | 1-800-1031-444 |
| USA | 855 670 3444 |
| UK | 08000 261 111 |
| HONG KONG | 800 906 444 |
| SINGAPORE | 1800 223 4444 |
| PRIVATE LINES | + 91 124 4425 444 |

www.theleela.com

PREFERRED HOTELS AND RESORTS WORLDWIDE

TOLL NUMBER 1 817 567 9633

Asia & Pacific

Australia, China, Hong Kong, India, Japan, Singapore, New Zealand, Taiwan, Thailand

Central & South America

Argentina, Brazil, Chile, Colombia

Europe

Austria, Belgium, France, Germany, Ireland, Italy, Netherlands, Norway, Russia, Spain, Sweden, Switzerland, UK

Middle East & Africa

Israel, South Africa, UAE

North America

Canada, USA, Mexico

www.preferredhotels.com



THE LEELA PALACE

UDAIPUR

The Leela Palaces, Hotels and Resorts: Bengaluru, Chennai, Jaipur, New Delhi, Udaipur, Bhartiya City Bengaluru, Delhi, Gandhinagar, Gurugram, Mumbai, Ashtamudi, Kovalam.

