

# KOVALAM • KERALA



**THE LEELA**

KOVALAM

A RAVIZ HOTEL

## Places of interest

Sri Padmanabhaswamy Temple

15 Kms

The Golf Club 18 Kms

Museum and Art Gallery

18 Kms

Poovar Backwaters 20 Kms

Elephant Camp 45 Kms

Lion Safari and Crocodile Park

45 Kms

Ashtamudi Lake (Houseboat Cruise)

80 Kms

Kanyakumari 85 Kms

Kerala Arts & Crafts Village 3.3 Kms

*The Leela Kovalam, a Raviz Hotel, built on a cliff-top and spread over acres of lush greenery, is cradled between wide sweeping beaches and has a panoramic view of the famous Kovalam coastline.*

## Climate

In summer, the min is 30°C  
and the max is 40°C

In winter, the min is 23°C  
and the max is 32°C

## General information

Languages: English, Malayalam,  
Tamil, Hindi

Currency: Indian Rupee

All major credit cards

*KERALA*

# KOVALAM

This luxury resort, with an array of superlative restaurants and lounges, also specializes in traditional Ayurvedic treatments. Two stunning infinity pools overlook the Arabian Sea.

The Club has an exclusive infinity pool, Library Lounge and Living Room and is perched on a cliff overlooking the sea.

*[www.theleela.com](http://www.theleela.com)*

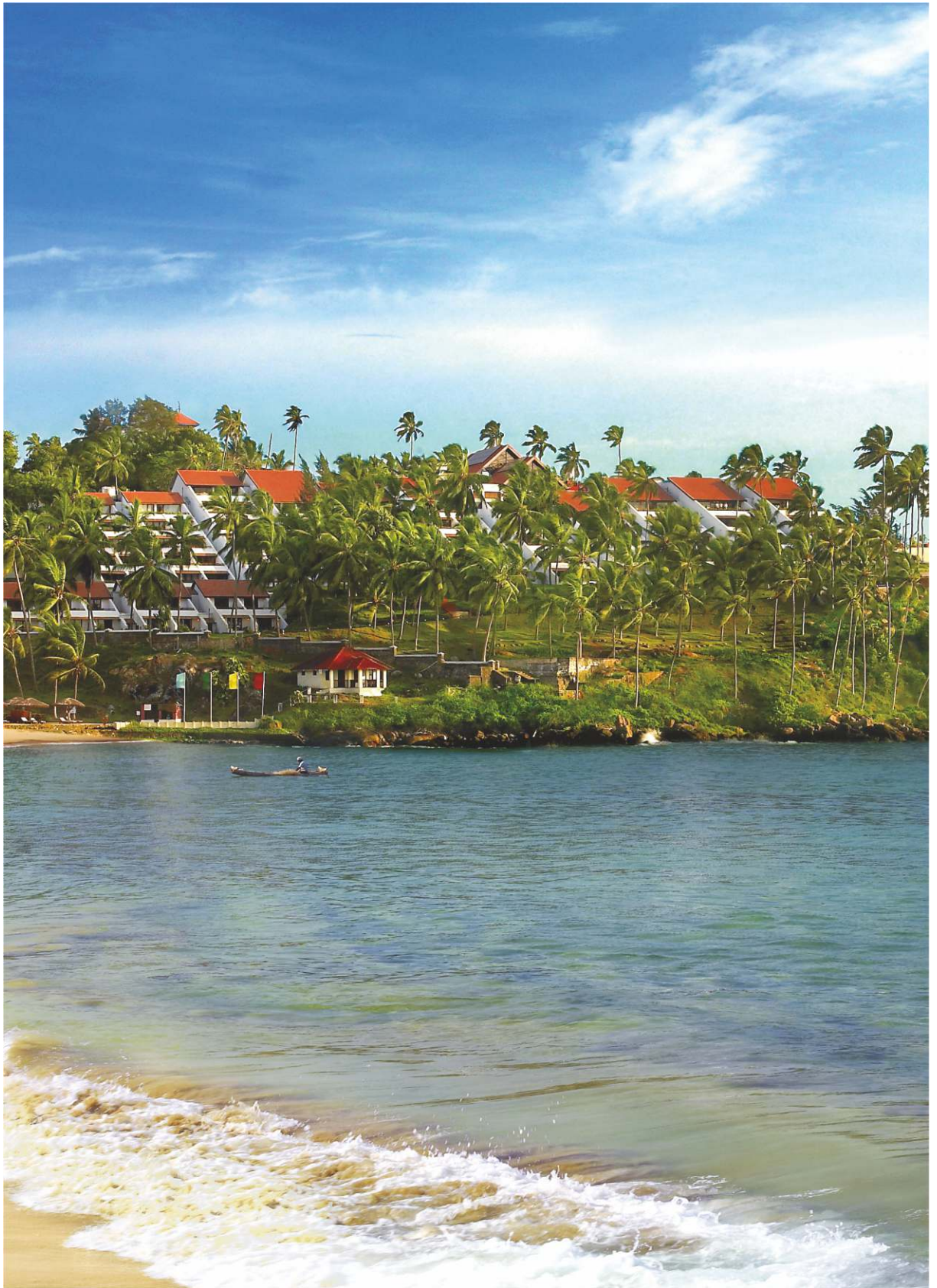

The Leela Kovalam, a Raviz Hotel

*Welcome to a place where the age old Indian tradition of "Atithi Devo Bhava", meaning "Guest is God", is a way of life. At The Leela, everyone is committed to taking guest service to reverential heights.*

### *Accommodation*

- Total no. of suites and rooms - 188
- 19 Garden View Villa
- 22 Sea View Villa
- 84 Premier Sea View Rooms
- 49 Royal Club Rooms
- 6 Royal Club Suites
- 1 Royal Club Duplex Suite
- 1 Ocean View Suite
- 2 Presidential Suites
- 4 Kovalam Palace Suites

### *Guestroom Amenities*

- High definition LED television
- High speed internet connectivity
- Electronic safe
- A gourmet corner with fine selection of spirits, soft beverages and snacks
- Tea and coffee maker
- Luxurious bathroom with a walk-in shower
- Power supply: 110 / 220 volts

### *Guestroom Services*

- In-room dining
- Laundry and dry cleaning
- Concierge service
- Wake-up call service
- Doctor / Nurse on call

### *The Club*

- Cliff-top location
- Sea view wing with entry for Club residents only
- Club lobby with private check-in and check-out
- The Café with alfresco dining
- The Living Room
- The Library
- Sundeck Lounge
- The Club pool
- Personalised butler service on call
- Exclusive usage of Club gym

### *Dining*

- The Terrace - All-day dining
- The Tides - Pan Asian Seafood Speciality restaurant
- The Café (Exclusively for Club residents)
- The Bar
- The Sky Bar - with a stunning view of the Kovalam coastline

### *Conference & Banquet*

#### *Facilities*

- Convention centre
- 3 Boardrooms
- Beachside events
- Pandhal - A traditional Kerala style non air- conditioned hall
- Maya banquet hall

### *Spa and Fitness*

- Ayurveda and wellness spa
- State-of-the-art fitness studio
- Three swimming pools (one exclusively for Club residents)
- Yoga and meditation centre with daily sessions for guests
- Archery
- Tennis
- Badminton
- Table tennis
- Billiards

### *Special Features*

- Sightseeing tours and day picnics
- Children's play room
- Currency exchange
- Organic Garden



Infinity Pool at The Club



Ayurveda and Wellness Spa

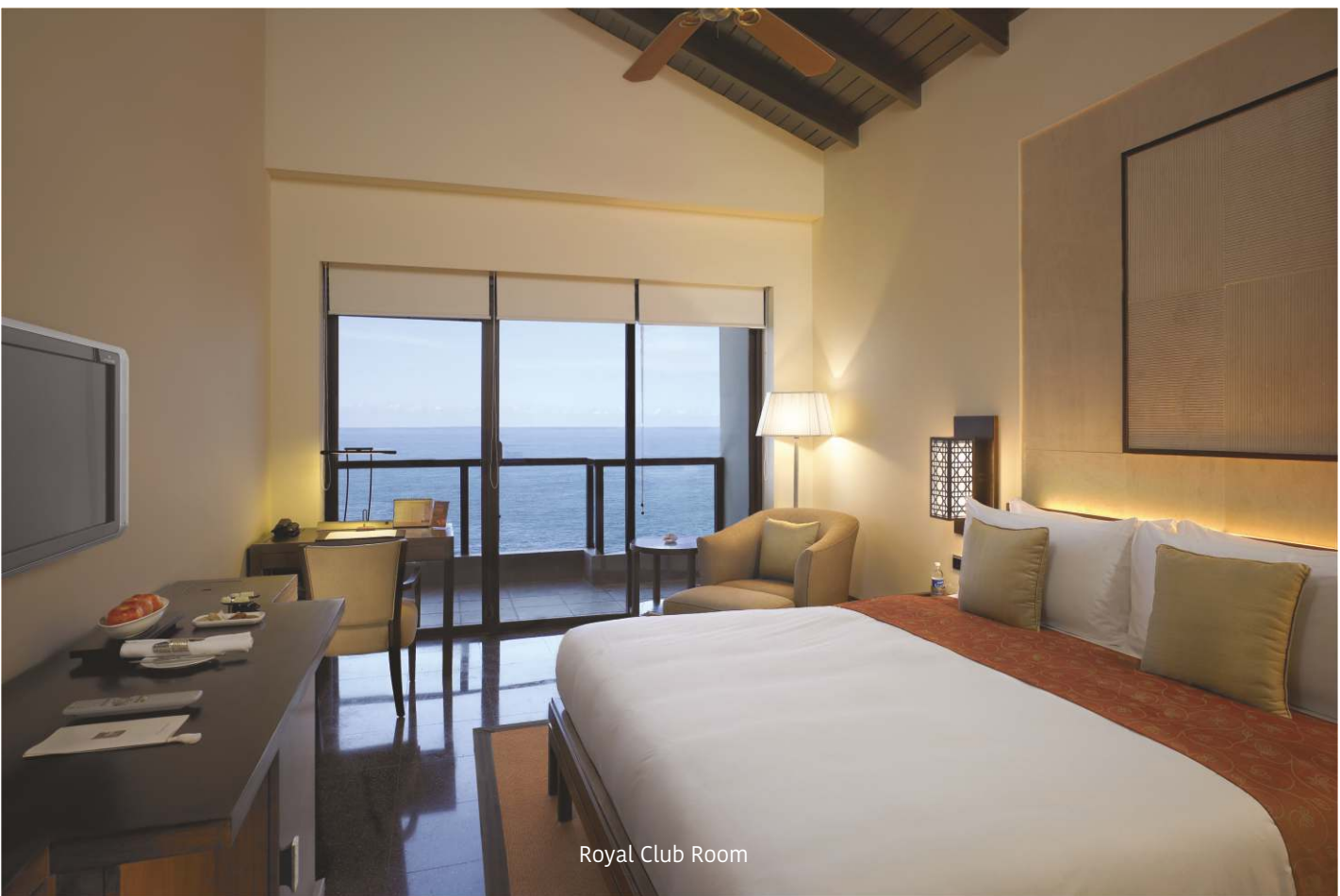

Royal Club Room

# BANQUET AND MEETING ROOM FLOOR PLAN

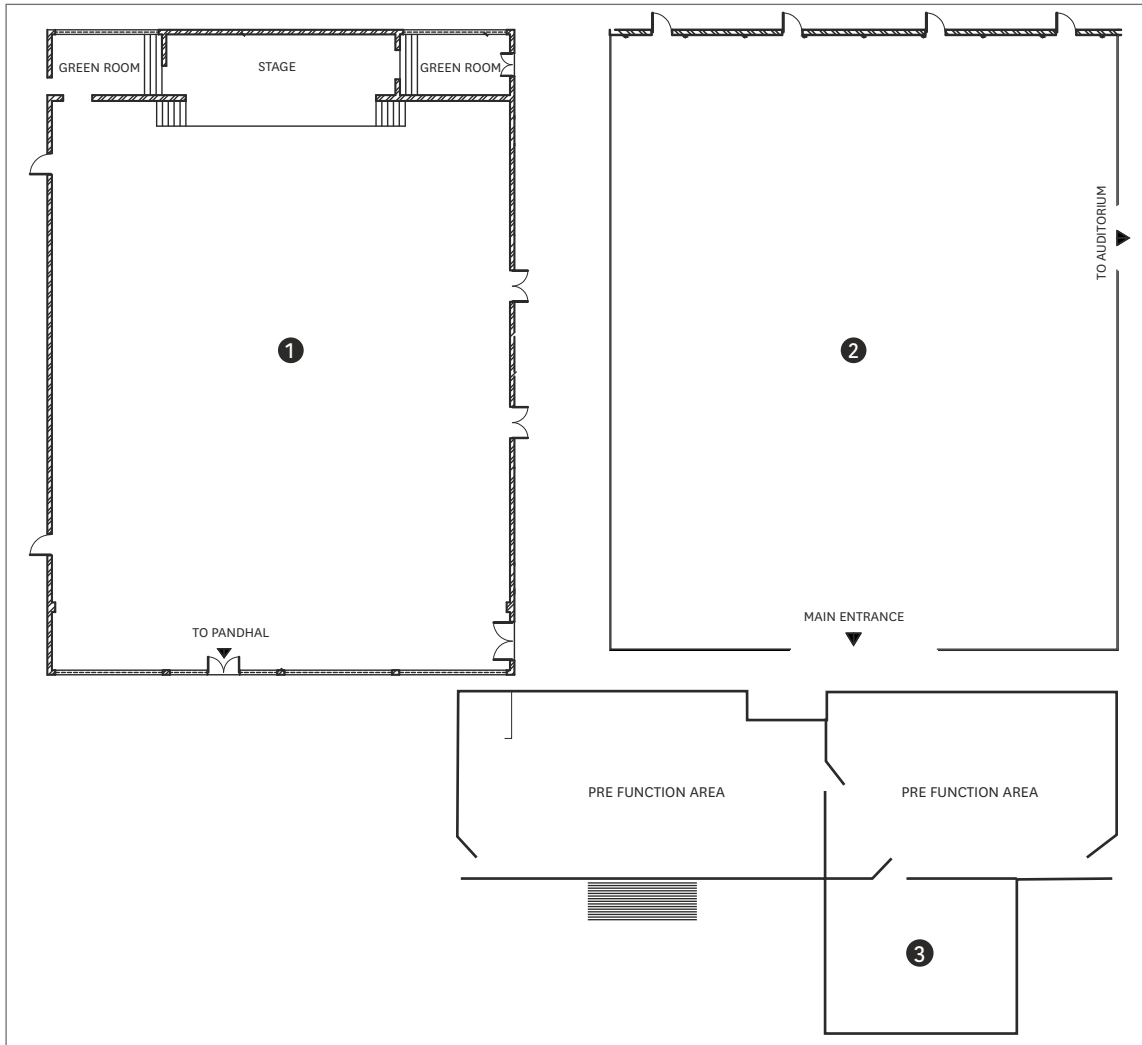

① CONVENTION CENTRE    ② PANDHAL    ③ MAYA

| VENUE                           | AREA<br>SQ. FT. | DIMENSIONS<br>L x W x H | THEATRE<br>STYLE | CLASS<br>ROOM | U<br>SHAPE | BOARD<br>ROOM | ROUND<br>TABLE | CLUSTER<br>STYLE | RECEPTION | SADYA |
|---------------------------------|-----------------|-------------------------|------------------|---------------|------------|---------------|----------------|------------------|-----------|-------|
| <b>A/C Hall</b>                 |                 |                         |                  |               |            |               |                |                  |           |       |
| Convention Centre               | 7390            | 96 x 77 x 22            | 750              | 400           | 100        | 150           | 400            | 280              | 750       |       |
| Maya                            | 920             | 49 x 19 x 10            | 60               | 36            | 24         | 40            | 48             | 40               | 80        |       |
| <b>Boardroom / Meeting Room</b> |                 |                         |                  |               |            |               |                |                  |           |       |
| Roshni                          | 540             | 21 x 21 x 10            |                  |               |            | 20            |                |                  |           |       |
| Tara                            | 370             | 25 x 15 x 10            |                  |               |            | 14            |                |                  |           |       |
| Meeting Room                    | 1195            | 53 x 22 x 8             |                  |               |            |               |                | 50               |           |       |
| <b>Semi Open / Non A/C Hall</b> |                 |                         |                  |               |            |               |                |                  |           |       |
| Pandhal                         | 6640            | 90 x 74 x 22            | 400              | 200           | 100        | 100           | 200            | 180              | 400       | 180   |
| <b>Outdoor Venue</b>            |                 |                         |                  |               |            |               |                |                  |           |       |
| Chesspark                       | 5856            | 96 x 61                 | 400              |               |            |               | 200            |                  | 400       |       |
| Beach                           | 16000           | 200x 800                | 900              |               |            |               | 400            | 400              | 900       |       |



**TRANSPORTATION**

International Airport, 15 km  
 Domestic Airport, 15 km  
 Trivandrum City Centre, 13 km

**The Leela Kovalam, a Raviz Hotel**  
 Thiruvananthapuram 695 527 Kerala, India  
 Tel: + 91 471 305 1234  
 Fax: + 91 471 248 1522  
 E mail:reservations@theleela.com

**RESERVATIONS & INFORMATION**

**THE LEELA PALACES, HOTELS AND RESORTS**

**GDS CHAIN CODE: LR**

**THE LEELA RESERVATIONS**

**WORLDWIDE TOLL FREE**

|                      |                          |
|----------------------|--------------------------|
| INDIA                | 1-800-1031-444           |
| USA                  | 855 670 3444             |
| UK                   | 08000 261 111            |
| HONG KONG            | 800 906 444              |
| SINGAPORE            | 1800 223 4444            |
| <b>PRIVATE LINES</b> | <b>+ 91 124 4425 444</b> |

[www.theleela.com](http://www.theleela.com)

**PREFERRED HOTELS AND RESORTS WORLDWIDE**

**TOLL NUMBER** 1 817 567 9633

**Asia & Pacific**

Australia, China, Hong Kong, India, Japan, Singapore, New Zealand, Taiwan, Thailand

**Central & South America**

Argentina, Brazil, Chile, Colombia

**Europe**

Austria, Belgium, France, Germany, Ireland, Italy, Netherlands, Norway, Russia, Spain, Sweden, Switzerland, UK

**Middle East & Africa**

Israel, South Africa, UAE

**North America**

Canada, USA, Mexico

[www.preferredhotels.com](http://www.preferredhotels.com)



**THE LEELA**

**KOVALAM**

**A RAVIZ HOTEL**

The Leela Palaces, Hotels and Resorts: Bengaluru, Bhartiya City Bengaluru, Chennai, Delhi / New Delhi, Gandhinagar, Gurugram, Jaipur, Kovalam, Mumbai, Udaipur. Opening Shortly: Ashtamudi

