

JAIPUR



THE LEELA PALACE

JAIPUR

Places of interest

Amber Fort
Jaigarh Fort
Nahargarh Fort
City Palace
Hawa Mahal
Jantar Mantar
(The Observatory)
Centres that specialise in
semi precious stones and
jewellery

*The Leela Palace Jaipur is
an elegant reflection of
modern palatial grandeur.
Located amidst tranquil
environs the hotel is set
against the majestic backdrop
of the Aravalli range.*

Climate

In summer, the min is 28°C
and the max is 45°C
In winter, the min is 6°C
and the max is 19°C

General information

Languages: English,Hindi,
Marwari
Currency: Indian Rupee
All major credit cards

JAIPUR

Inspired by the luxury of yesteryear, yet staunchly modern in its execution, 194 lavishly appointed rooms, suites and villas offer luxuriant indulgence. Uncompromising in its decadence, bespoke and personalized services are delivered with a traditional finesse that embodies the spirit of both the locale and the signature Leela Service.

www.theleela.com

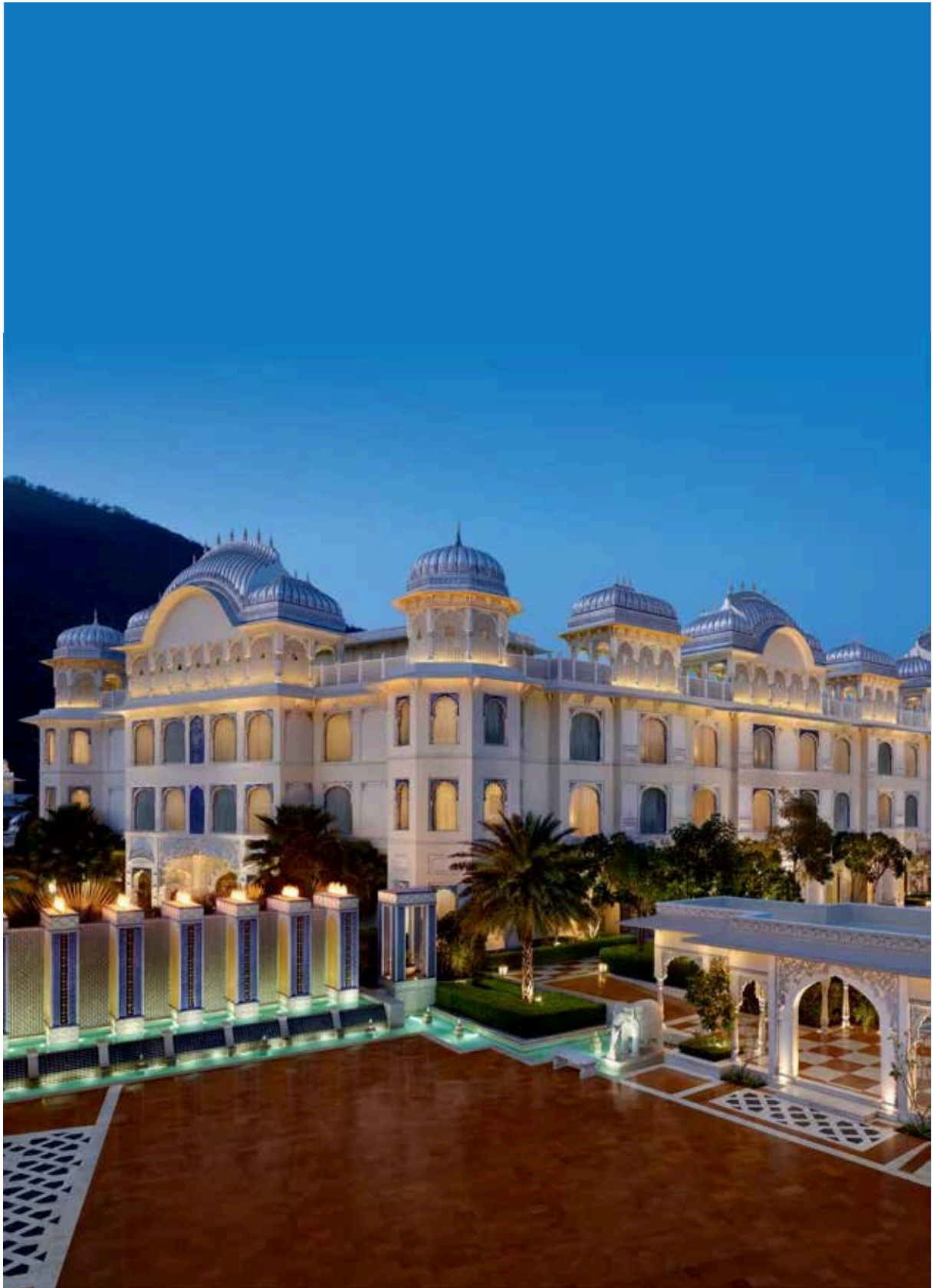

The Leela Palace Jaipur

Welcome to a place where the age old Indian tradition of “Atithi Devo Bhava”, meaning “Guest is God”, is a way of life. At The Leela, everyone is committed to taking guest service to reverential heights. “Welcome to a world of grandeur & luxury”

Accommodation

- Total no. of suites and rooms - 194
- 36 Palace Room King
- 38 Palace Room Twin
- 16 Palace Suites
- 12 Grand Villa King
- 10 Grand Villa Twin
- 22 Grand Villa with Terrace
- 10 Royal Villa with Courtyard King
- 7 Royal Villa with Courtyard Twin
- 35 Royal Villa with Plunge Pool
- 6 Royal Suite
- 1 Maharaja Suite
- 1 Maharani Suite

Guestroom Amenities

- High Definition LED Smart television
- Broadband wireless high speed internet
- Electronic safe
- Ergonomic mattress
- A gourmet corner with fine selection of spirits, soft beverages and snacks
- Tea and coffee maker
- Luxurious bathroom with phone lines
- Power supply: 110/220 volts

Guestroom Services

- In-room dining
- Laundry and dry cleaning
- Concierge service
- Wake-up call
- Doctor on call

The Villas

- Welcome drink on arrival
- In-room check-in
- Exclusive dining
- Laundry (4 pieces)
- The Leela Palace Services

Dining

- Aravalli Dining Room - Global Cuisine Atelier
- Jharokha
- Jamavar - An Ode to Royal Kitchens of India
- The Peacock Lounge
- The Amber Terrace- Where Heritage Meets Hedonism
- Unique dining experiences Poolside, Hawa Mahal and In-villa (on request)

Conference & Banquet Facilities

- Vikram Aditya Grand Ballroom with a pre-function area
- Jaigarh Meeting Room
- Nahargarh Meeting Room
- Sundarban Lawns
- Hawa Mahal
- Kanishka Bagh
- Studio

Spa and Fitness

- Aujasya by The Leela SPA
- State-of-the-art gymnasium
- Outdoor swimming pool

Special Features

- Bicycles for guest use (on request)
- The Salon
- Chauffeur driven limousine
- The Leela Ceremonial Rituals
- Kids Club by The Leela



Jamavar



The Amber Terrace



The Peacock Lounge

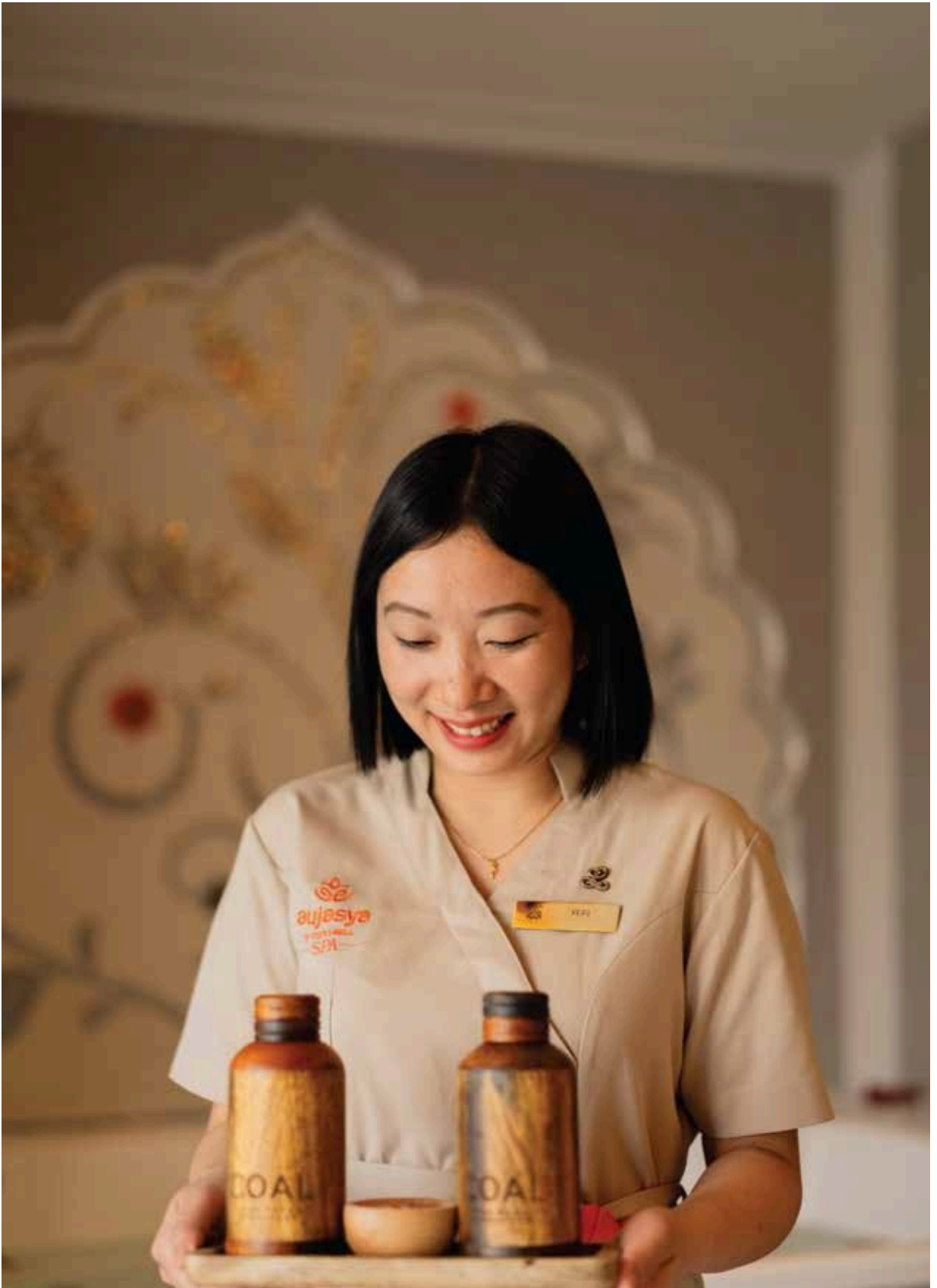

Aujasya by The Leela SPA



Maharaja Suite



Royal Villa with Courtyard



Royal Villa with Plunge Pool



Grand Suite



Grand Villa



Grand Villa with Terrace



Palace Room



Palace Suite

BANQUET & MEETING ROOM FLOOR PLAN

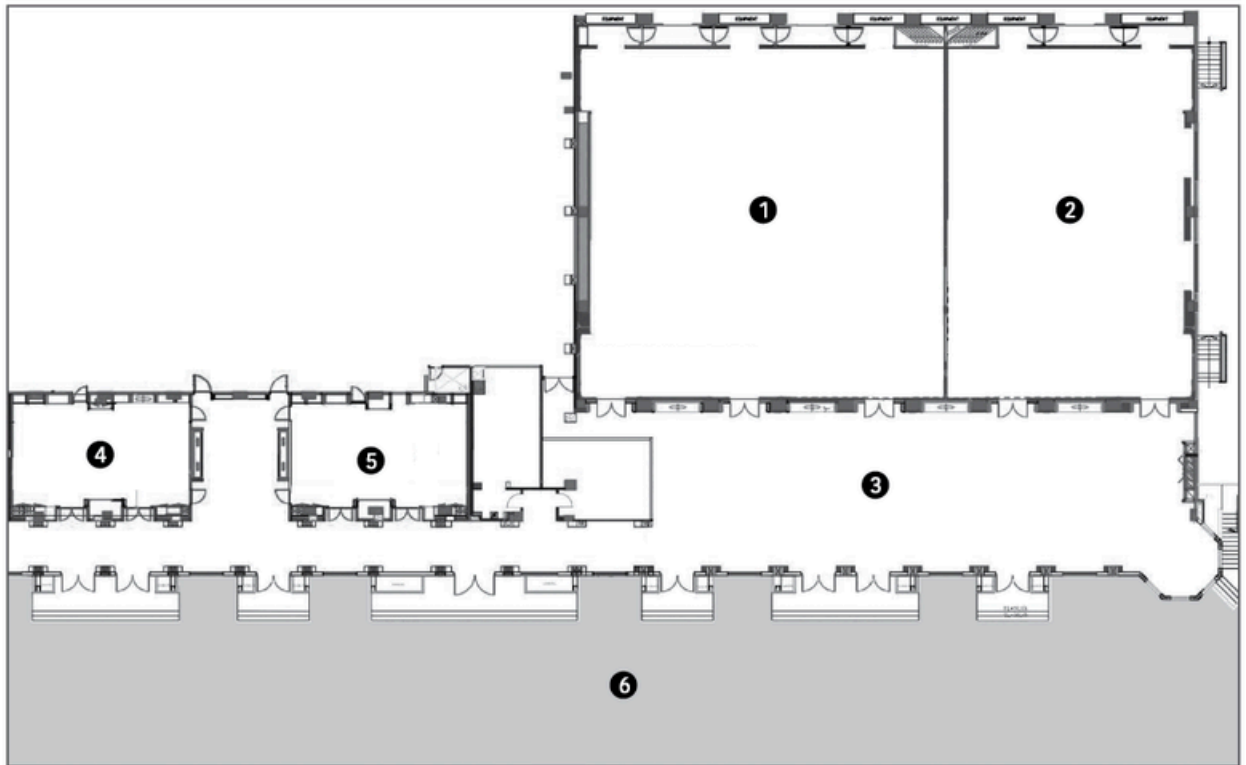

- ❶ Vikram Aditya - 1
 ❷ Vikram Aditya - 2
 ❸ Pre Function
 ❹ Nahargarh
 ❺ Jaigarh
 ❻ Sundarban Lawns

VENUE	AREA SQ. FT.	DIMENSIONS L x W x H	THEATRE STYLE	CLUSTER SEATING	CLASS ROOM	BOARD ROOM	U-SHAPE	BANQUET	RECEPTION
Ballroom									
Vikram Aditya 1 & 2	10906	130 x 75 x 22	800	420	400	130	130	800	800
Vikram Aditya 1	6560	79 x 75 x 22	500	230	225	60	60	400	300
Vikram Aditya 2	4346	51 x 75 x 22	275	170	100	50	50	200	150
Pre Function	4366	117 x 33 x 9							
Other Spaces									
Nahargarh	972	36 x 23 x 10	60	40	36	27	25	65	50
Jaigarh	972	36 x 23 x 10	60	40	36	27	25	65	50
Studio	448	28 x 16 x 7.8				12			
Meeting Room 1	390	28 x 14 x 7.8				12			
Meeting Room 2	390	28 x 14 x 7.8				12			
Open to Sky Spaces / Terrace									
Sundarban Lawns	33264	252 x 132		1000	700		250	1600	
Kanishka Bagh	7440	120 x 62						130	150
Hawa Mahal	12731	51 x 75 x 22	150	150	100			150	200

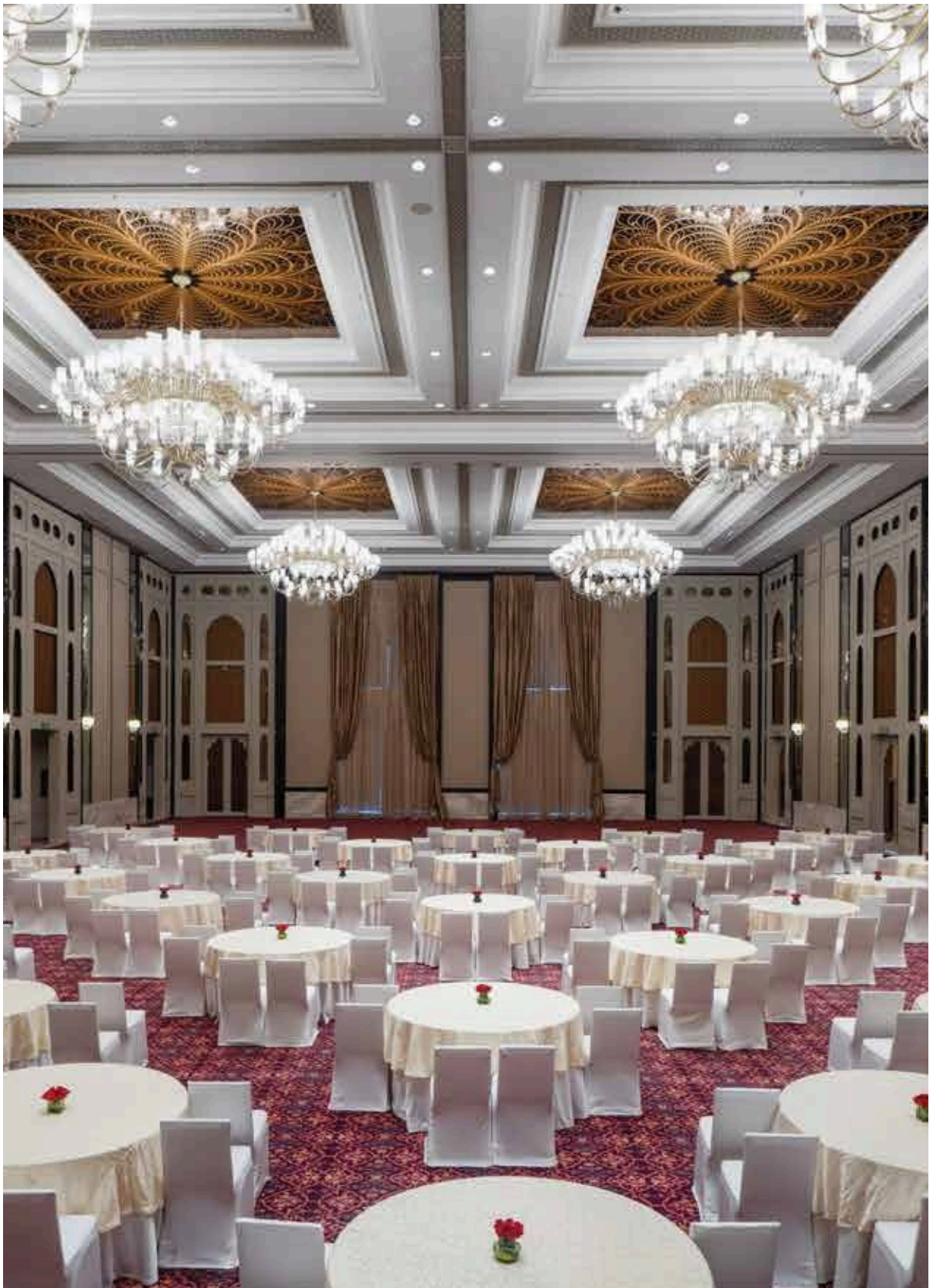

Vikram Aditya Ballroom

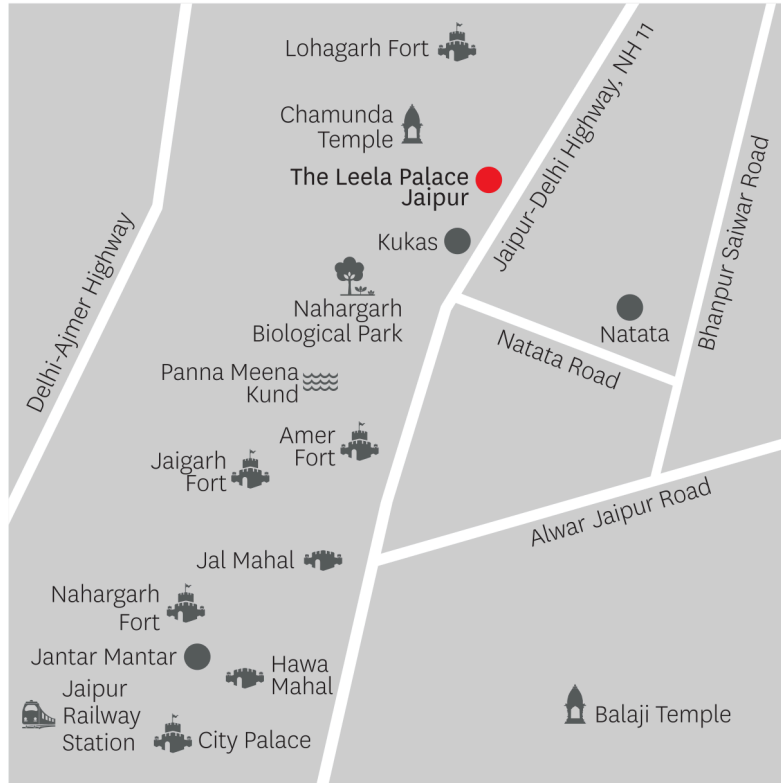

Transportation: International Airport, 30 kms | City Centre, 22 kms



THE LEELA PALACE

JAIPUR

The Leela Palace Jaipur: Jaipur - Delhi Highway, NH 11 Kukas, Jaipur 302 028 Rajasthan India | Tel: +91 142 6350000
For reservations: Call 1800 1031 444 | Email: reservations@theleela.com | www.theleela.com

Bengaluru, Chennai, Jaipur, New Delhi, Udaipur, Bhartiya City Bengaluru, Delhi, Gandhinagar, Gurugram, Mumbai, Kovalam, Ashtamudi and Hyderabad.