

JAIPUR



THE LEELA PALACE

JAIPUR

Places of interest

Amber Fort
Jaigarh Fort
Nahargarh Fort
City Palace
Hawa Mahal
Jantar Mantar
Centres that specialise in
semi precious stones and
jewellery

*Set amidst 12 acres of
beautiful landscaped gardens
and surrounded by the
majestic Aravalli mountains,
The Leela Palace Jaipur is a
fine example of royal Rajput
architecture and grandeur.
The hotel evokes the enduring
allure of Jaipur's rich and
glorious past and offers an
experience of royal living.*

Climate

In summer, the min is 28°C
and the max is 45°C
In winter, the min is 6°C
and the max is 19°C

General information

Languages: English, Hindi,
Marwari
Currency: Indian Rupee
All major credit cards

KUKAS

JAIPUR

Luxurious villas resplendent in old world charm, The Leela Palace Jaipur is a standing testimony of royal Rajput architecture. Opulent interiors, multiple dining options, exquisite banquet facilities, an indulgent spa and other modern amenities make it an ideal royal retreat for couples, families or for business meetings.

www.theleela.com



The Leela Palace Jaipur

Welcome to a place where the age old Indian tradition of "Atithi Devo Bhava", meaning "Guest is God", is a way of life. At The Leela, everyone is committed to taking guest service to reverential heights. "Welcome to a world of grandeur & luxury"

Accommodation

- Total no. of suites and rooms - 56
- 36 Premium Suites
- 4 Royal Suites
- 12 Grand Royal Suites
- 4 Presidential Suites

Guestroom Amenities

- Internet Protocol (IP) phones
- 3 phones in the rooms
- Spa mood lighting in all the bathrooms
- Broadband high speed internet access / Wi-Fi internet connectivity
- Electronic safe
- iPod based entertainment system including video on demand
- Fully stocked 'Gourmet Corner'
- Power Supply : 220 volts

Guestroom Services

- 24 hours Butler service
- Laundry and dry cleaning
- Concierge services
- Wake-up call service

Dining

- Dining Hall - All day dining restaurant
- The Library Bar
- Sheesh Mahal - Indian speciality restaurant
- Pool- side Bar & Lounge

Conference & Banquet

Facilities

- Shahi Bagh - The Royal Garden
- Chandra Mahal - The Open Terrace
- Meeting Room

Spa and Fitness

- Extensive spa
- State of the art fitness centre
- Weather controlled swimming pool studio
- Beauty salon

Special Features

- Elephant Rides
- Horse Back Riding
- Guest Bicycles
- Palace Musicians
- Butler Service
- Palace musicians
- Concierge



Inner courtyard



Shahi Bagh Promenade



Heritage room

BANQUET & MEETING ROOM FLOOR PLAN

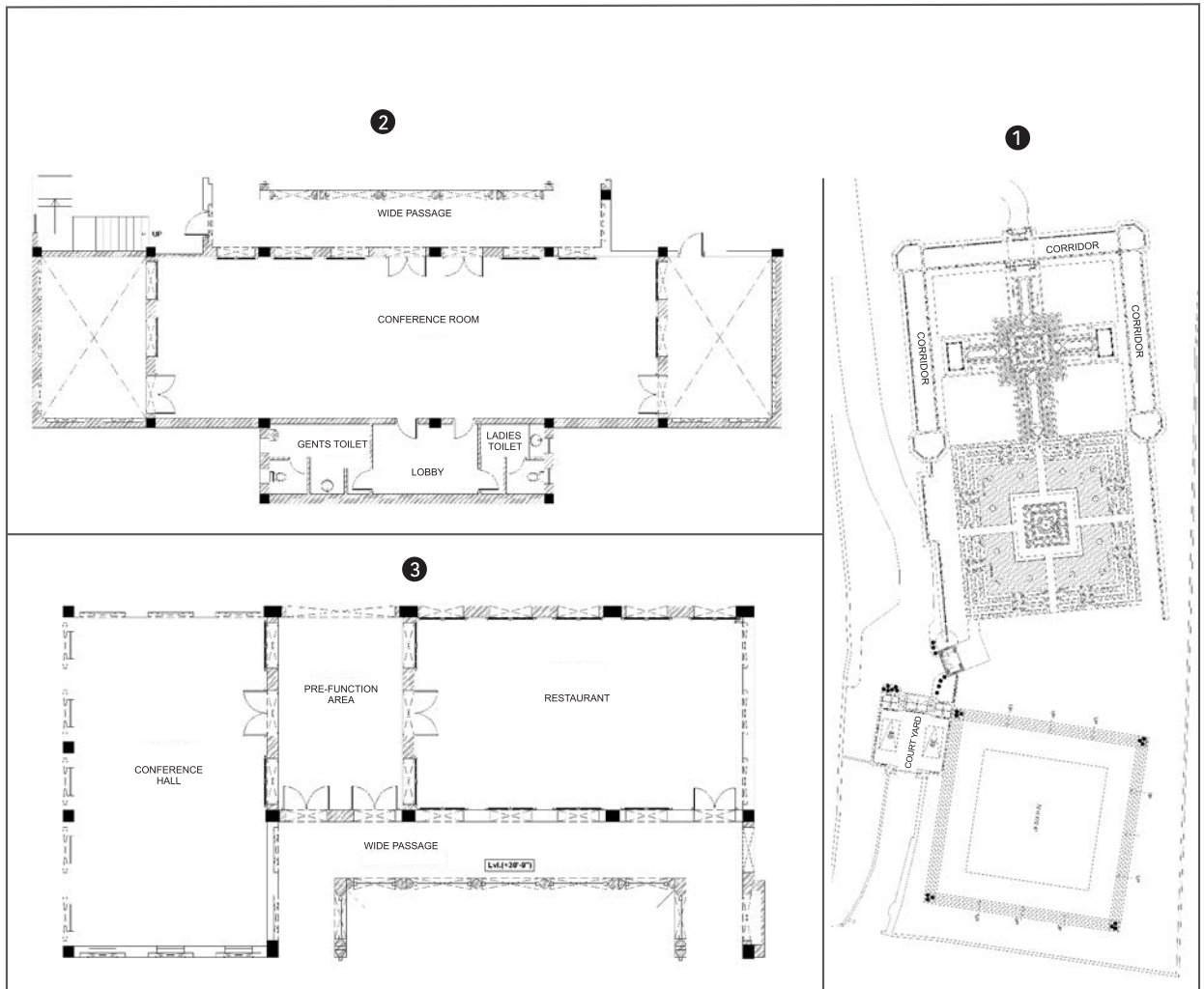

- ① Shahi Bagh - The Royal Garden
- ② Maharaja Conference Hall
- ③ Meeting Room

VENUE	AREA SQ. FT.	DIMENSIONS L x W x H	THEATRE STYLE	CLASS ROOM	U-SHAPE	BOARD ROOM	BANQUET	RECEPTION
Shahi Bagh - The Royal Garden	20000		800	600			1500	2100
Chandra Mahal - The Open Terrace	3379	74 x 51	300	150			120	150
Maharaja Conference Hall	1407	66 x 21 x 11	135	70	20	18	100	145
Meeting Room	770	36 x 21 x 11	75	40	12	10	60	80

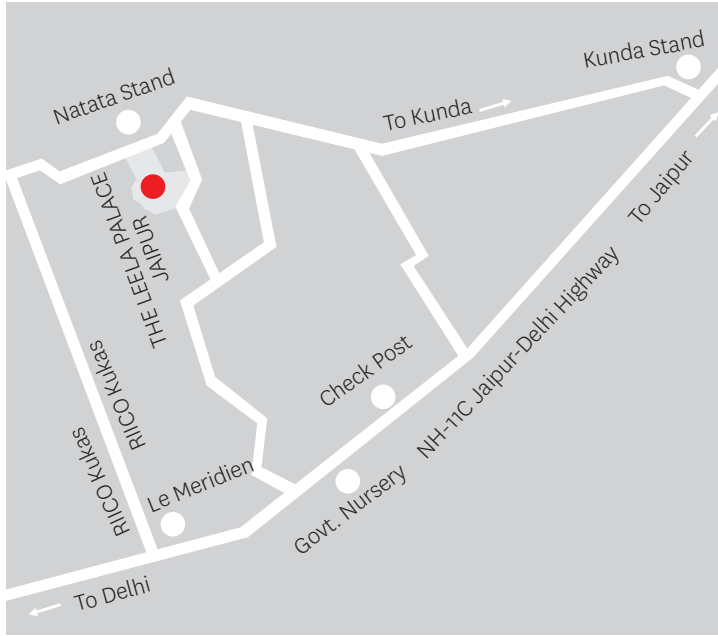

TRANSPORTATION

International Airport, 30 km
 City Centre, 22 km

The Leela Palace Jaipur
 Natata, Near RICO Kukas,
 Jaipur 302 028 Rajasthan India
 Tel: +91 142 6510510
 Fax: +91 142 6510511
 e mail :reservations.jaipur@theleela.com

**RESERVATIONS & INFORMATION
 THE LEELA PALACES, HOTELS AND
 RESORTS**

GDS CHAIN CODE: LR
 THE LEELA AMBIENCE GURGAON
 RESERVATIONS 91 124 477 1177
 www.theleela.com

PREFERRED HOTELS AND RESORTS

TOLL FREE
 CANADA/USA 1 800 323 7500

Austria, Denmark, France,
 Germany, Italy, The Netherlands,
 Spain, Sweden,
 Switzerland and UK 00800 32375001

Australia 1 800 134 271
 Hong Kong, SAR 800 96 3365
 Japan 0120 984 450
 Singapore 1 800 227 3126
 Taiwan 00801 65 1254

PHG WORLDWIDE TOLL
 NUMBER 1 817 567 9633
 www.preferredhotels.com



THE LEELA PALACE

JAIPUR

The Leela Palaces, Hotels and Resorts: New Delhi, Bengaluru, Chennai, Mumbai, Gurgaon, Udaipur, Goa and Kovalam.
 Upcoming Hotels: Jaipur; Agra; Lake Ashtamudi (Kerala); Bhartiya City, Bengaluru and Lucknow.